

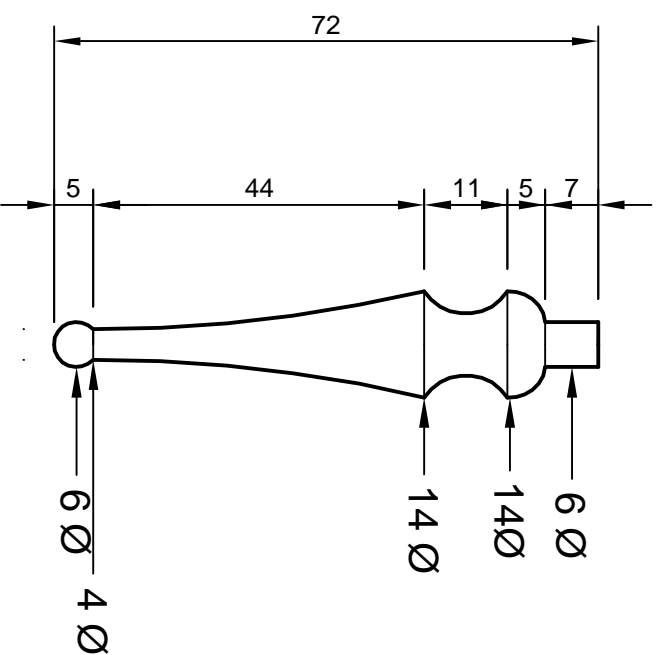

Inside-out Christmas Ornament
 by Brian Kirkby
 The tea light is a battery operated light,
 not a real candle!



Between Legs Finial Scale: Full size

INSIDE-OUT CHRISTMAS ORNAMENT

by courtesy of Brian Kirkby

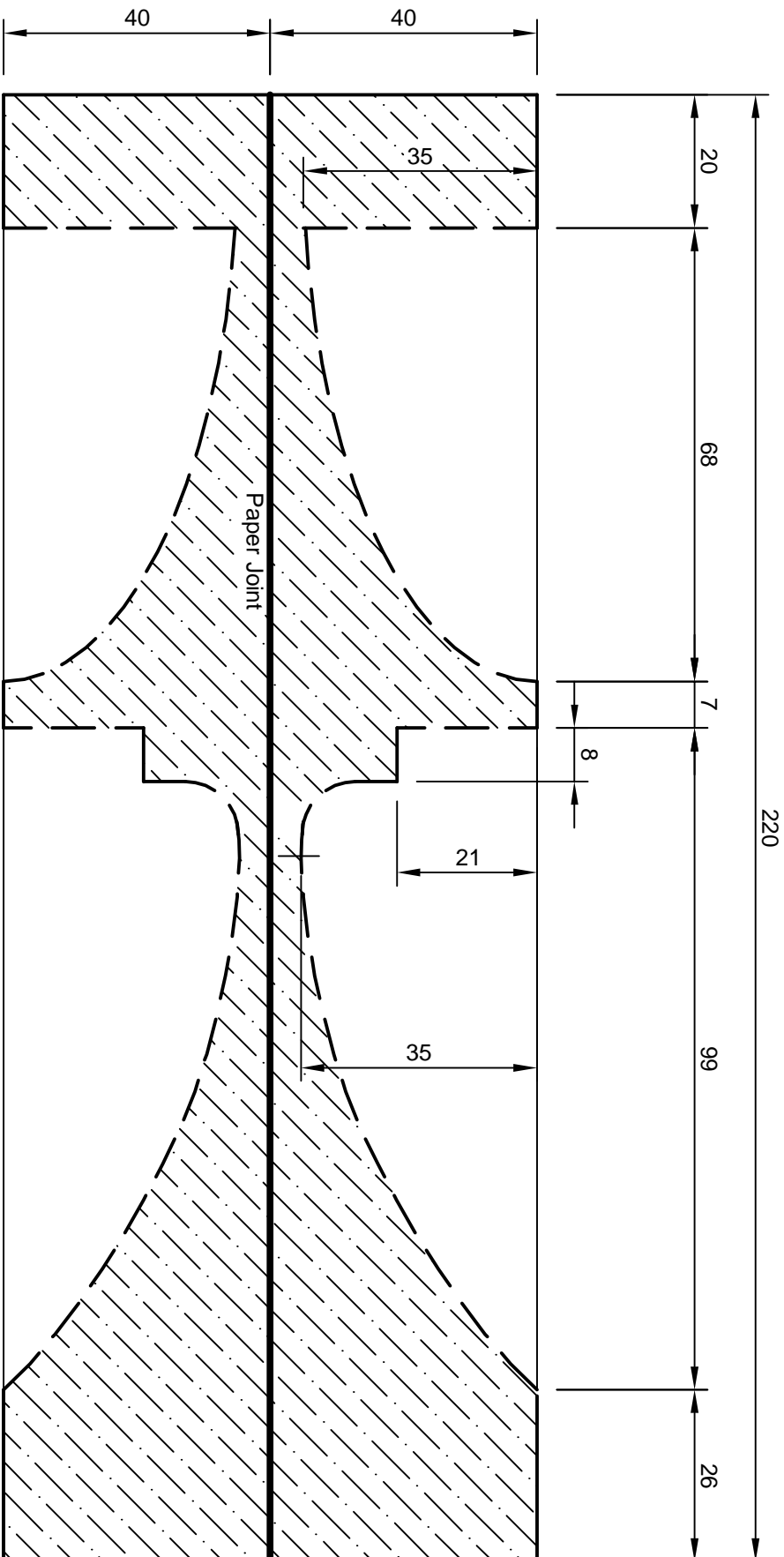

Step 1. - turning the inside Scale: Full size

The turning blank uses 4 pieces of 40mm x 40mm x220 timber glued together with paper joints to form an 80mm x 80mm x 220mm blank.

INSIDE-OUT CHRISTMAS ORNAMENT

by courtesy of Brian Kirkby

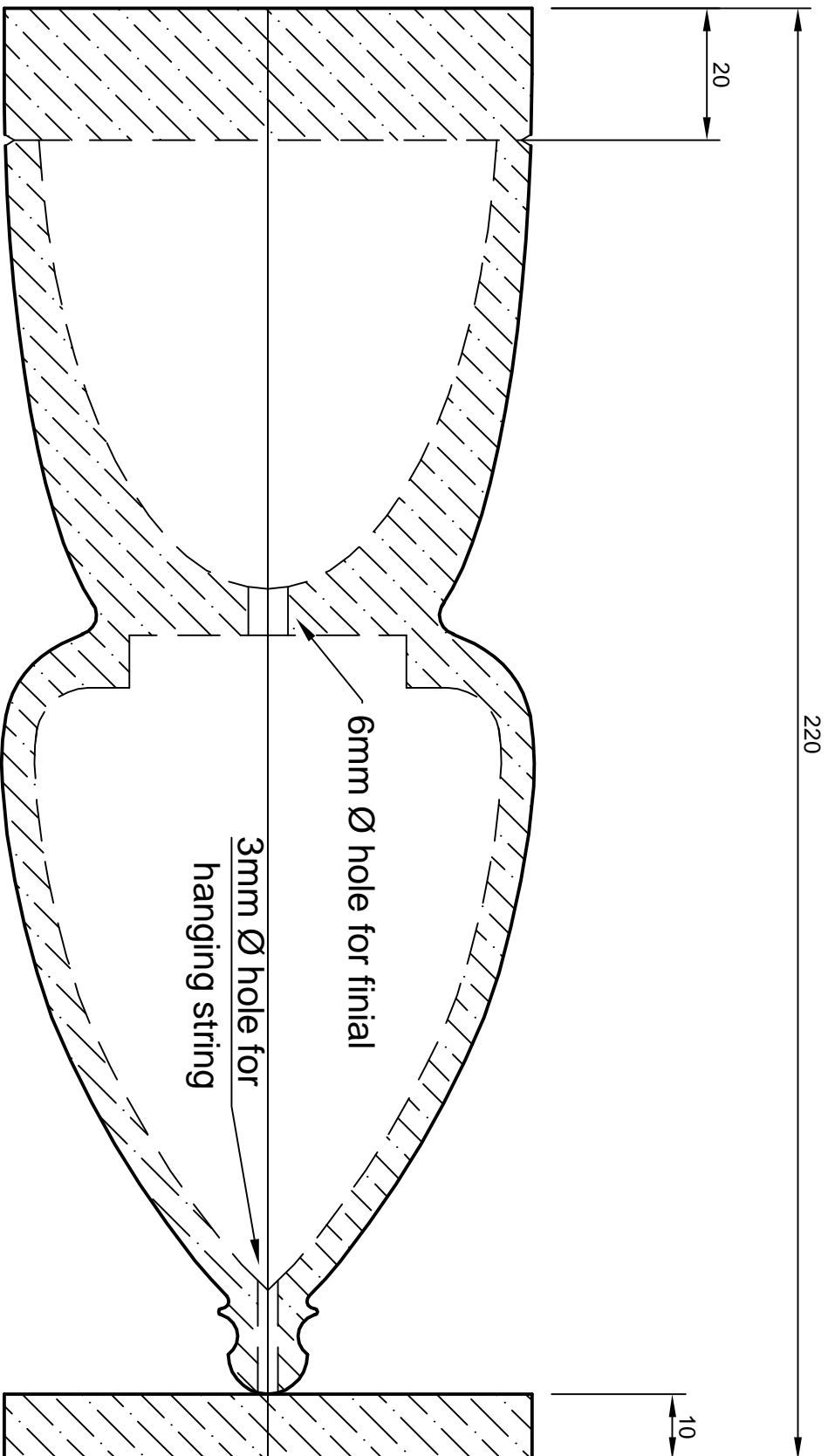

Step 2. - turning the outside Scale: Full size

INSIDE-OUT CHRISTMAS ORNAMENT

by courtesy of Brian Kirkby

drawn by: Richard Barkman - August 2020